

Doric, Ionic, Corinthian

Christy Nyiri, Robert Pedersen, and Yasmine Whaley-Kalaora

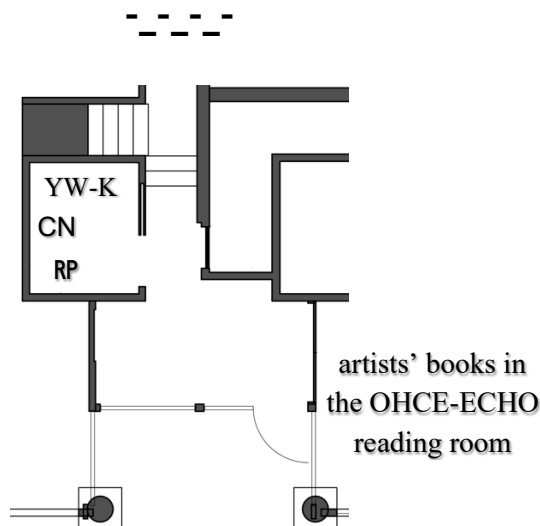

OHCE-ECHO, 1469 Venables

Open every Saturday in February, 12–4pm, and by appointment.

All are welcome to a mid-exhibition celebration with the artists, on Wednesday, February 12, 6–8pm.

Christy Nyiri has lived in New York since 2014, and has worked as a self-taught designer and web developer since 2007. Christy graduated from Emily Carr Institute of Art and Design in 2005 with a degree in Integrated Media.

She was a founding member of Norma, with Vanessa Kwan, Diana Lopez-Soto, Josh Neelands, Pietro Sammarco, Erica Stocking, Ron Tran, and Kara Uzelman, an artist collective active from 2001 to 2014—

Norma was awarded a 2011 Mayor's Arts Award for recognition as an Emerging Artist in Public Art, nominated by Barbara Cole. In 2006 Christy co-founded Weekend Leisure, a self-described “art/karaoke/comedy/video collective”, with Erich Gerl, Curtis Grahauer, and Pietro Sammarco. In collaboration with Khan Lee, she produced the artist's book *Korean Phrasebook: 200 Ways to Speak in Song!* Christy's solo practice has long included drawing, and in the mid-2000s, she created several self-portraits as twins—I previously exhibited the drawing in this exhibition at Lucky's Comics in 2009.

ROBERT PEDERSEN, A NEW FOUND-OBJECT SCULPTURE EVERY WEEK OR SO, MATERIALS AND DIMENSIONS VARIABLE

Christy Nyiri, untitled, 2009, graphite on paper, 50.8 x 50.8 cm

Yasmine Whaley-Kalaora, *RWFFS*, 2021

*Writing after a former self by another "reader, writer, former figure skater."*¹

video: 1 minute, 46 seconds; installation: iPhone, plastic phone case treated with acetone, stainless steel hardware and swivel hook, wooden dowel, rope made from skating tights used 2002–15, height-adjustable, dimensions variable

¹ a nod to *Food 4 Thot* podcast host Denne Michele Norris; poster design by Kiel Torres and Christian Vistan.

Robert Pedersen lives and works in Vancouver and on Quadra Island, primarily doing fencing work and outdoor building projects. Rob previously owned and operated the bookstore Chroma Books (4458 Main St, 2001–08), and Solder and Sons (247 Main St, 2008–13—RIP \$2 Americanos), a bookstore-as-cafe, opened in partnership with David Grove, initially as a means to collaborate with other artists to build electronic instruments, and to perform in mixed groupings and settings around the lower mainland, indoors and out. Rob's earliest efforts at book publishing resulted in the booklet *Preamble* (2007), for the Perro Verlag series *Hell Passport*. Recent bookworks include *Tusks* (2024), and a new publication created for this exhibition. His recent art practice consists of a series of hurried, blunt sculptures that suggest a bewildered approach to architecture and contemporary design—documented @doubles_ as on Instagram. His temporary public sculptures can sometimes be found along road verges in East Vancouver.

Yasmine Whaley-Kalaora lives between the unceded territories of the xʷməθkʷəy̓əm, Skwxwú7mesh and Səlílwəta? and the K'ómoks First Nation, where she works as a writer and critic, as a studio assistant for Tom Burrows, and in archives for artists and artist-run organizations. Over the last year, Yasmine has been working on experimental audio pieces under the mentorship of Brady Ciel Marks, including recent collaborations with her sister, Derya Whaley-Kalaora, for *split-lip-glue-seam* at Boombox, and with Chipo Chipaziwa and Hannah Sofia Eriksson for *Tomato Gossip* at What Lab. She holds a BA Art History from the University of British Columbia, where she was a curator for the Hatch Art Gallery (2019–20). Since 2022, she has been curating C.L.A.M., an intermittent series pairing short films with performance art, readings, and the occasional supper club. Yasmine's solo practice includes sculptures and time-based visual and audio works, mostly created alone, and—as I see it—with an underlying sense of both humour and pathos, centred on slippage/s of language/s, the porousness of self/ves, and the passing of time.

OHCE-ECHO

> <http://bedroomkitchen.garden/ohce-echo>